

This map illustrates the St. Lawrence Valley, a major agricultural and industrial region in Quebec, Canada. Key features include:

- Major Cities and Towns:** Montreal, Quebec, Saguenay, Sherbrooke, Trois-Rivières, Lével, and various smaller towns like St. Jean, St. Hubert, and St. Basile.
- Geographical Features:** The St. Lawrence River, Saguenay Fjord, and numerous lakes and islands.
- Infrastructure:** Major highways (e.g., 100, 15, 10, 1000) and rail lines.
- Scale:** A scale bar at the bottom indicates distances in kilometers (0 to 100) and miles (0 to 100).

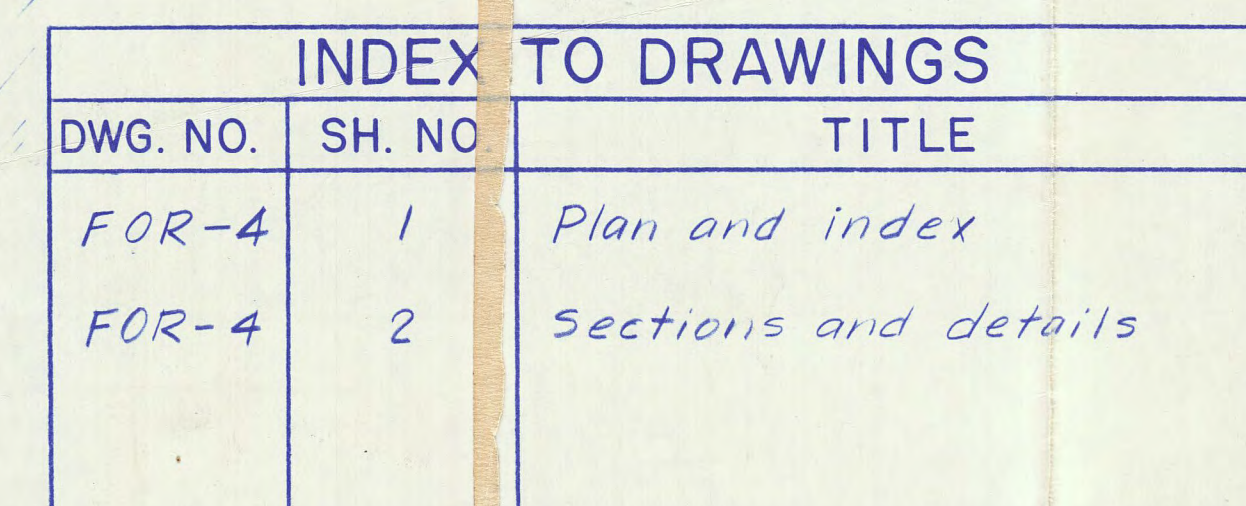

NOTES:

1. Topography from survey of 3 Dec. 1987
2. Contractor to contact local utility for the relocation of existing pole 21/55 during construction. Relocation of pole to be done by Utility Co.
3. Existing 8" water main is estimated to be 3' below channel invert at the culverts and approximately 8' below ground (Coverage).

[illegible]

PRELIMINARY - NOT FOR ISSUE -

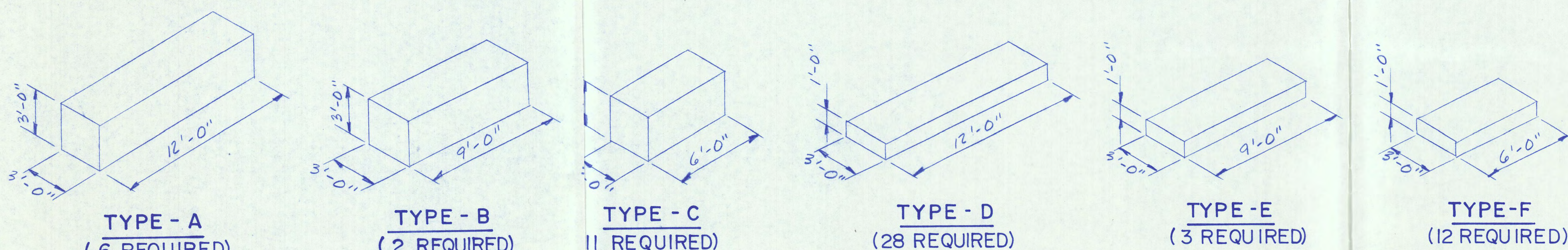
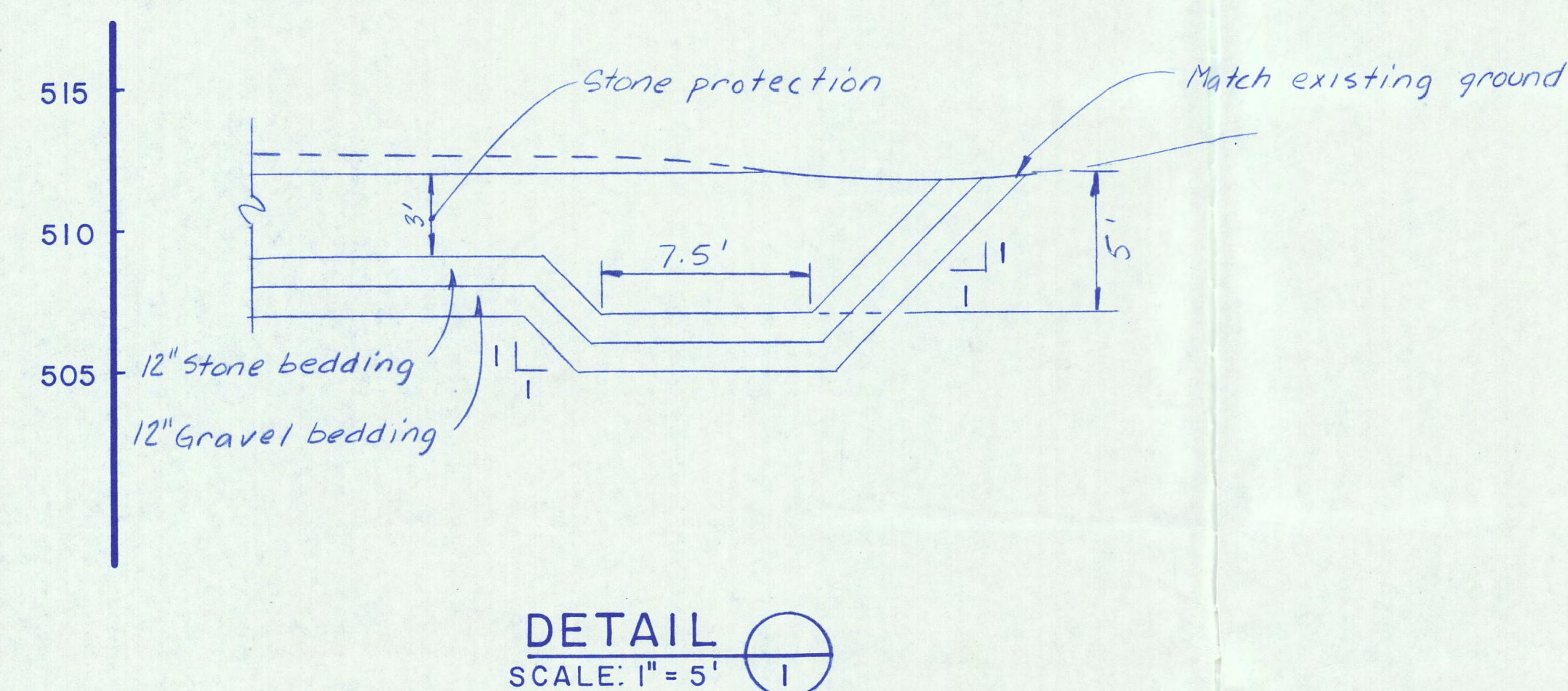
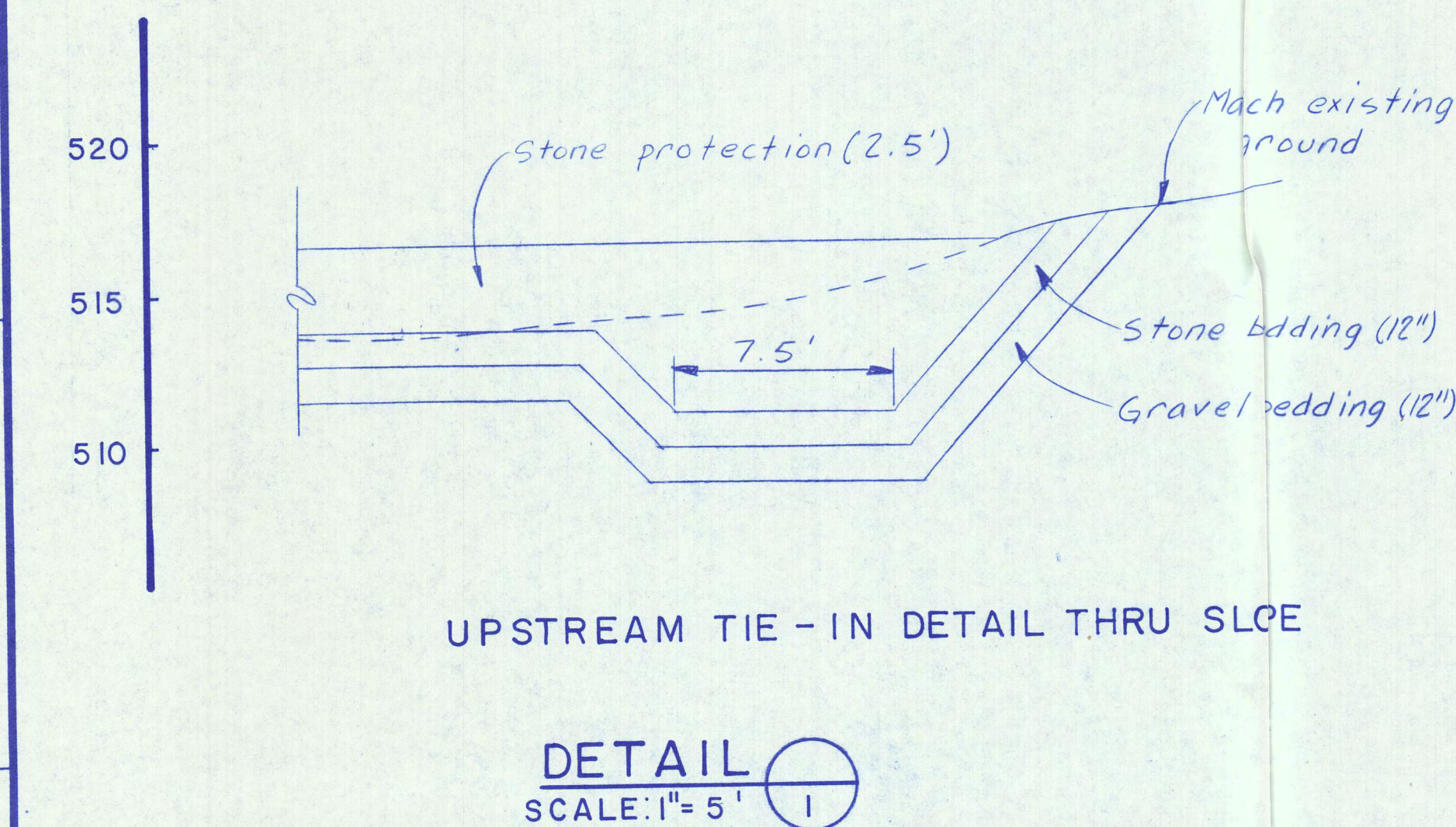
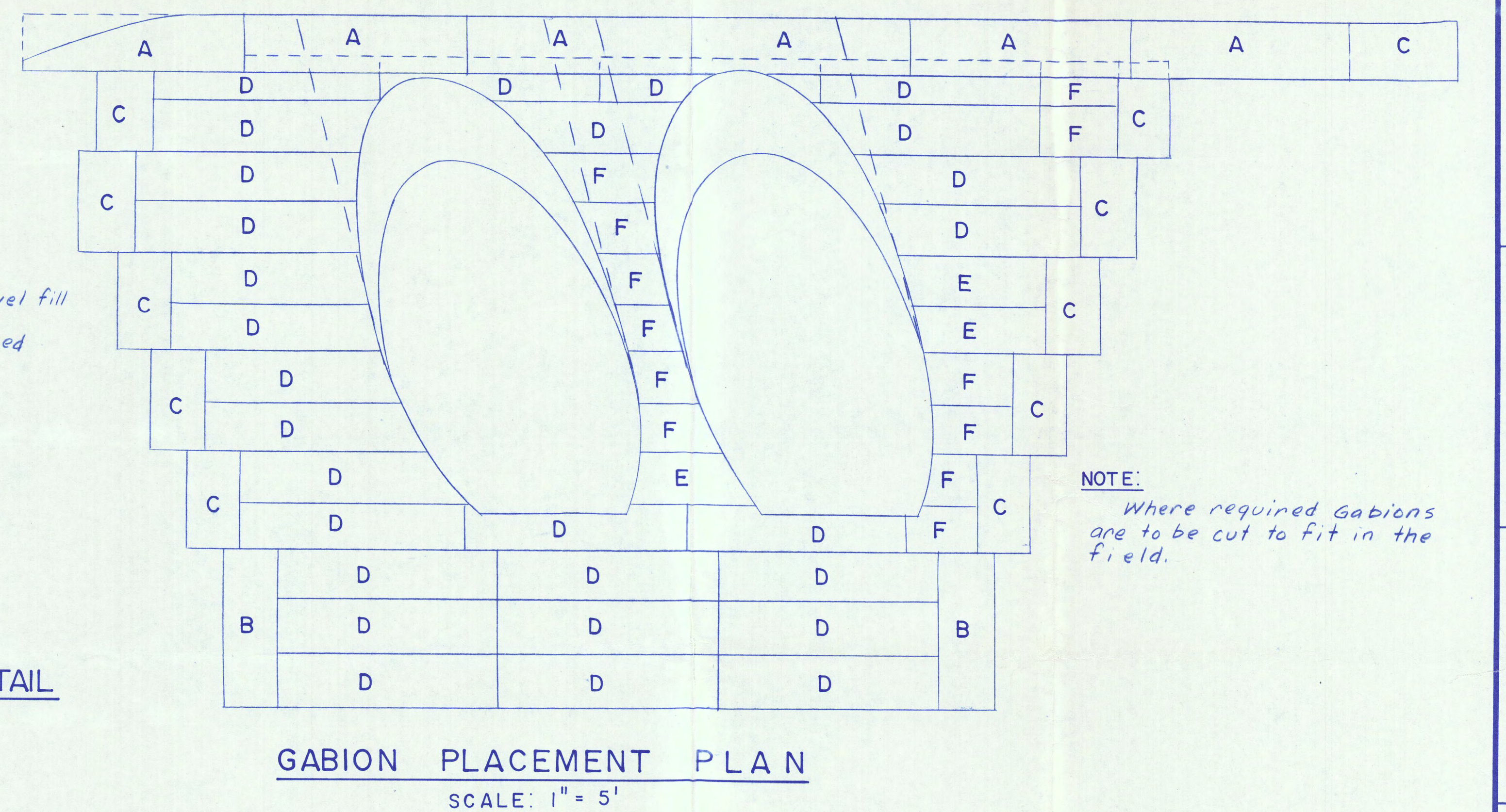
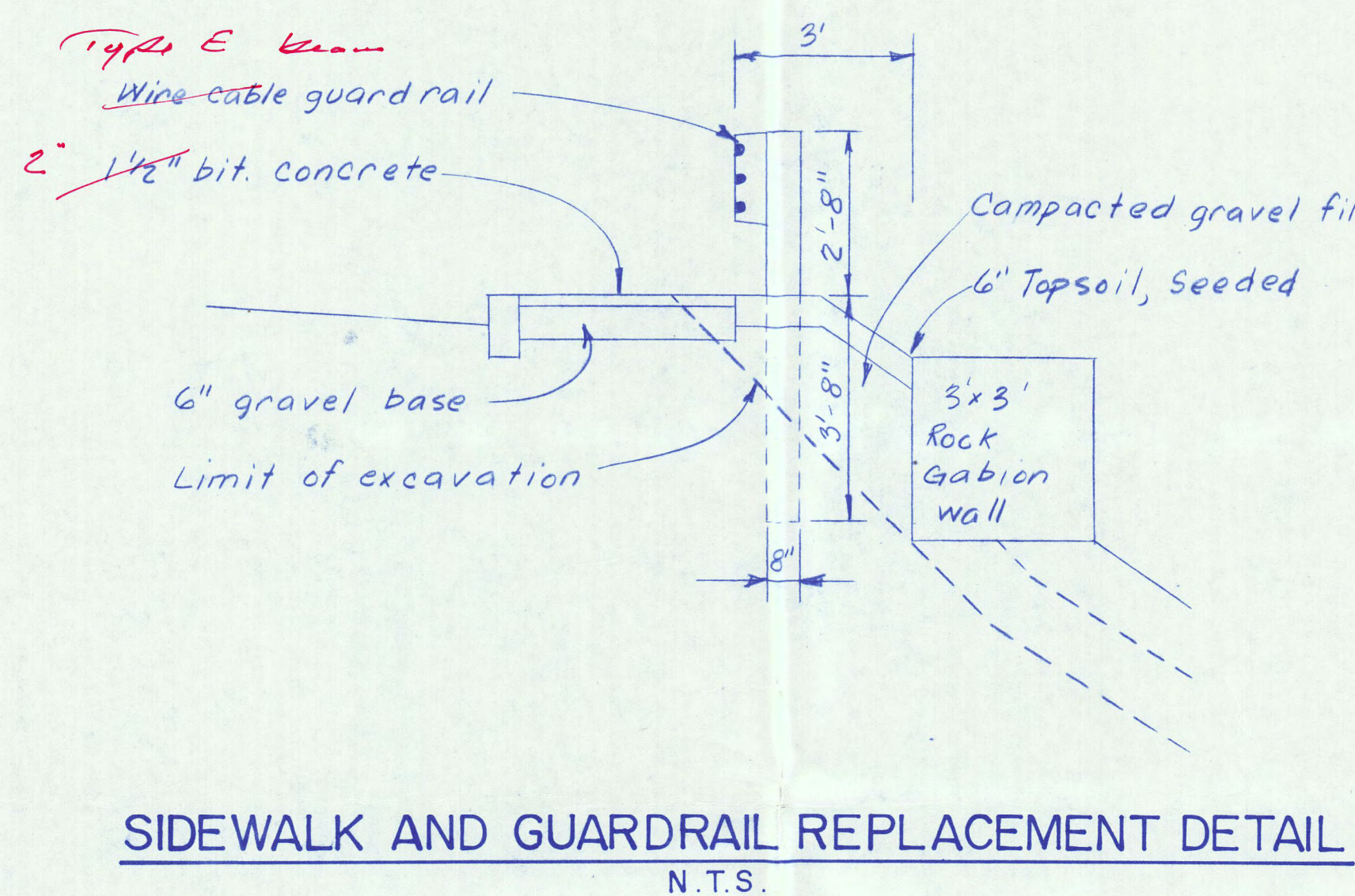
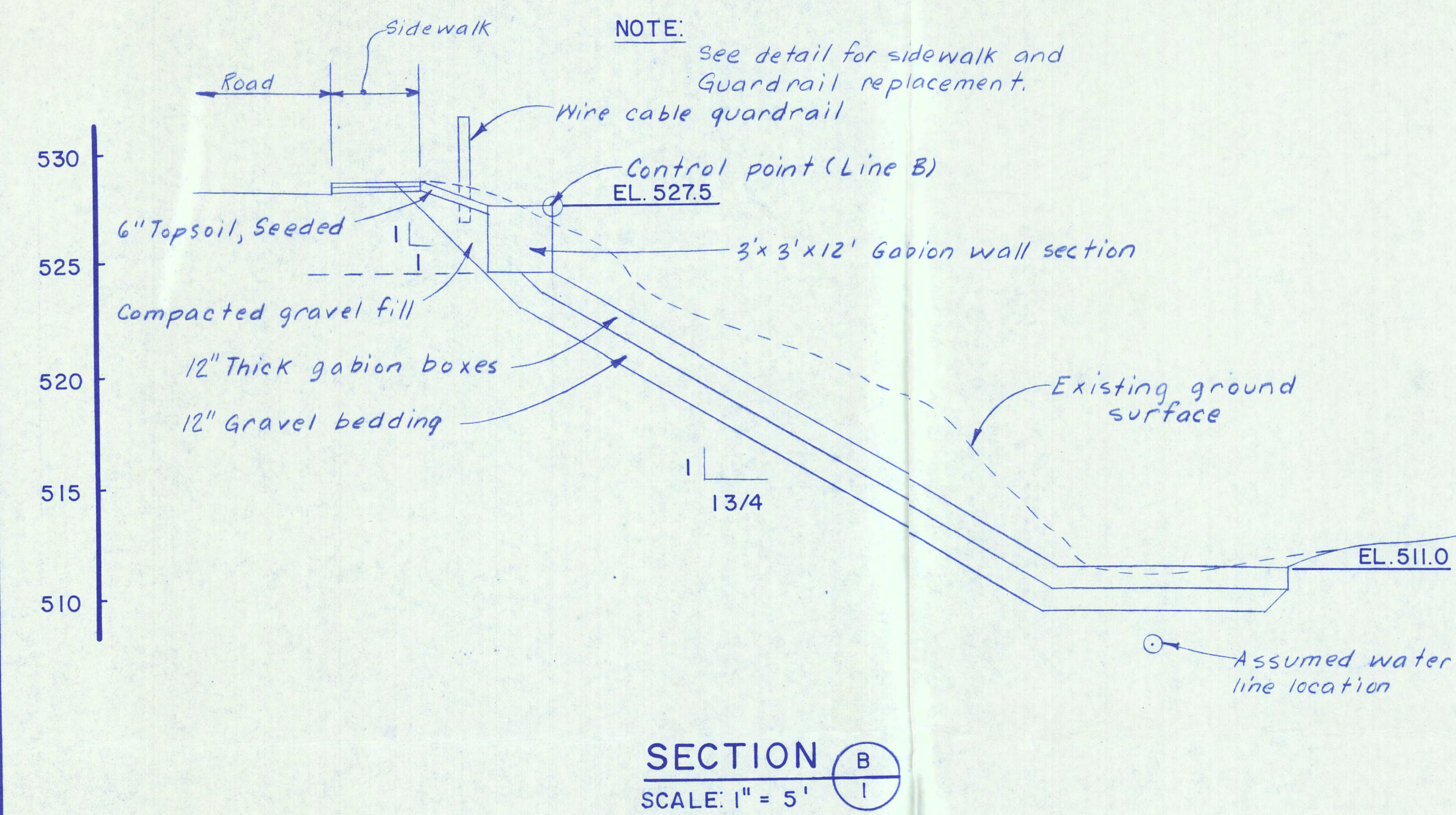
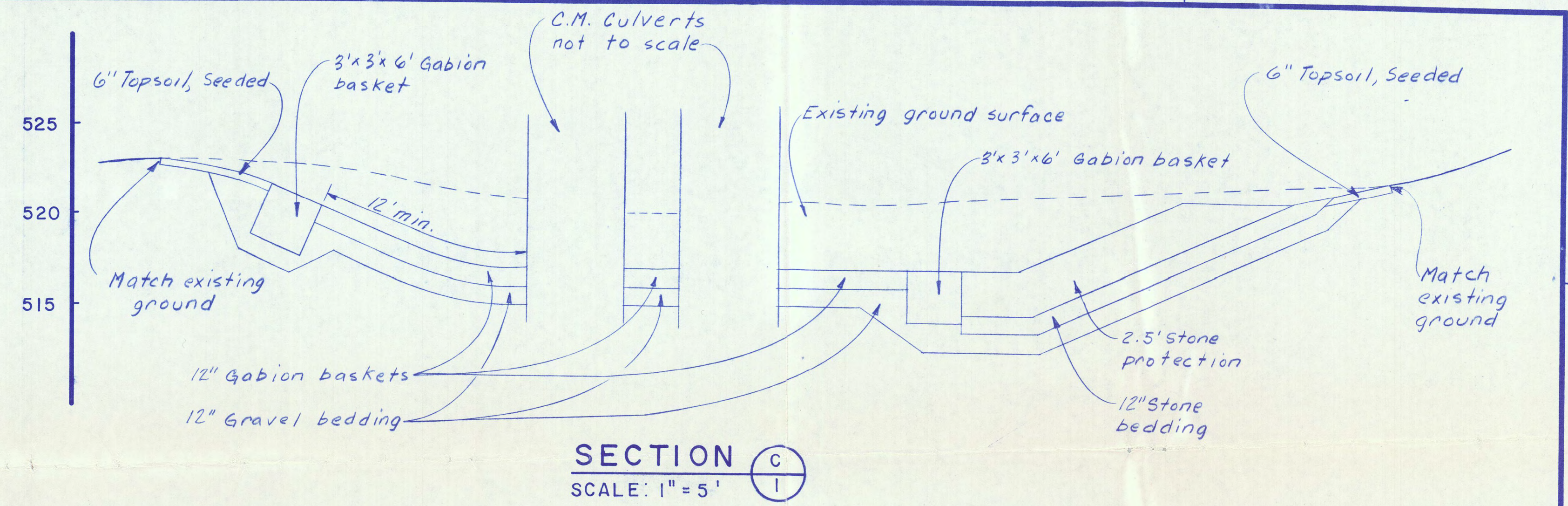
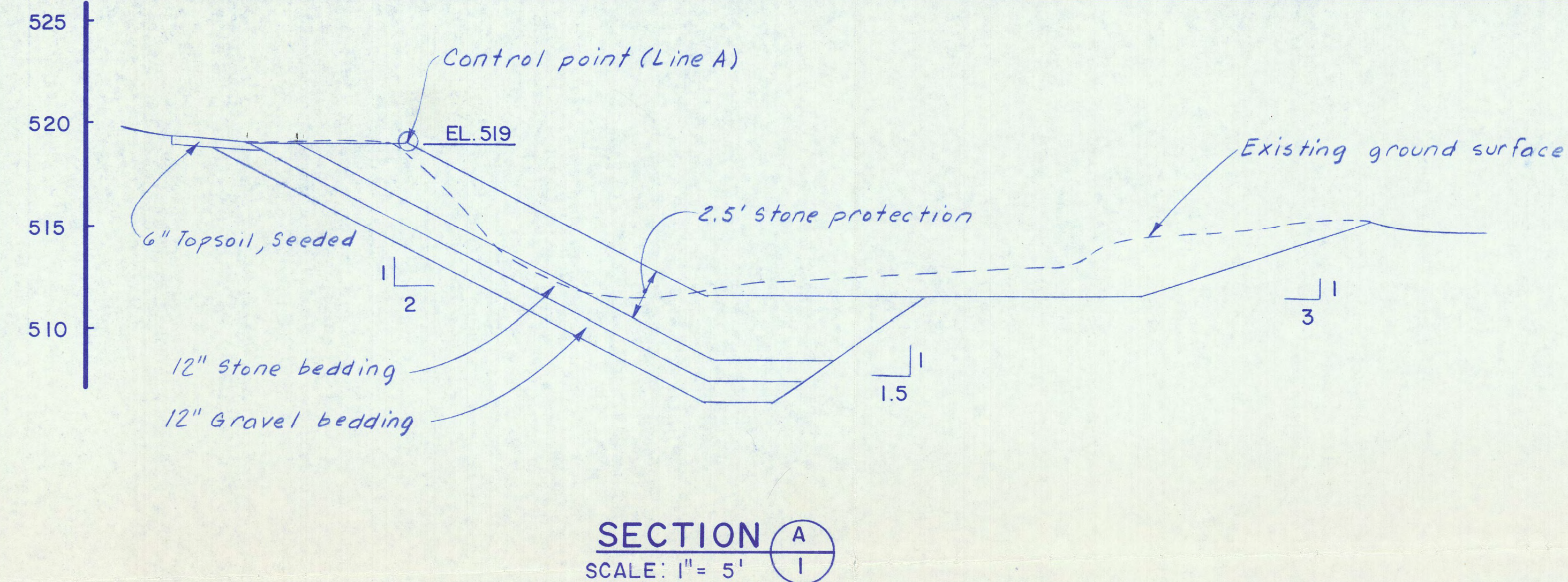

GRAPHIC SCALES

REVISION	DATE	DESCRIPTION	BY

DEPARTMENT OF THE ARMY
NEW ENGLAND DIVISION
CORPS OF ENGINEERS
WALTHAM, MASS.

DES. BY: M.D. DR. BY: R.F.E. CK. BY:

SUBMITTED:

APPROVAL RECOMMENDED:

REVIEWED:

PROJECT MANAGER:

APPROVAL RECOMMENDED:

CHIEF PROJECT MNGT. BRANCH:

CHIEF, ENGINEERING DIVISION:

SCALE:

SPEC. NO.

DRAWING NUMBER

FOR - 4

SHEET 2

PRELIMINARY - NOT FOR ISSUE